

注意！

FlyBook V2/V3 系列電腦允許使用者自行更換電腦內的硬碟。更換過程有拆裝鍵盤和硬碟模組的動作，必須非常小心。更換前，請務必詳細閱讀使用手冊中「更換硬碟」一節的說明。保固內容不包含因不當操作造成之任何損壞。

包裝箱內容物



FlyBook V2/V3 系列電腦快速啟動指南

1 安裝電池模組

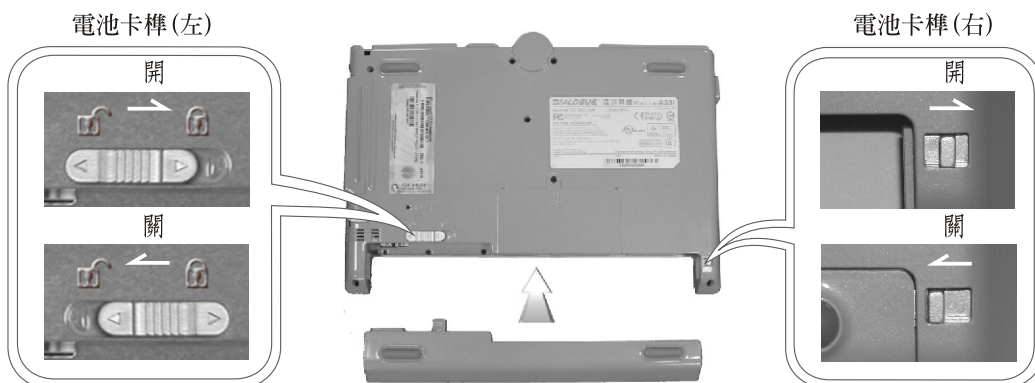

2 連接電源供應器供電



1. 將電源供應器與電腦端連接線確實連接。
2. 將電源供應器的電源端連接線插接電源插座，電腦端連接線插接電腦的電源插孔。

3 完成電腦的初始化設定



1. 打開螢幕並調整螢幕視角至舒適狀態。
2. 按"電源鍵"開機並使電腦執行開機程序。
3. 當開機程序執行完成螢幕會出現 Windows XP 初始化設定程序的歡迎畫面，請依程序指示完成設定，設定後即可使用電腦。

使用 FlyBook 電腦

請閱讀 FlyBook V2/V3 系列電腦使用手冊了解如何使用 FlyBook 電腦。

DIALOGUE

Cautions

FlyBook has been designed to allow users to change the internal hard drive to another IDE 2.5" standard one. To take this operation, it is necessary to remove the keyboard, replace the hard drives and then install the keyboard back. Like any other operations that can be done on FlyBook, carefully read related information in advance and do as the official documents say are absolutely necessary and important. The standard warranty does not cover any damage due to this either during or after the operation. Please refer to User's Guide or other sources indicated by Dialogue Technology Corp. when you are about to make a replacement.

What in your Package



Attaching power and initializing FlyBook

1 Installing battery pack

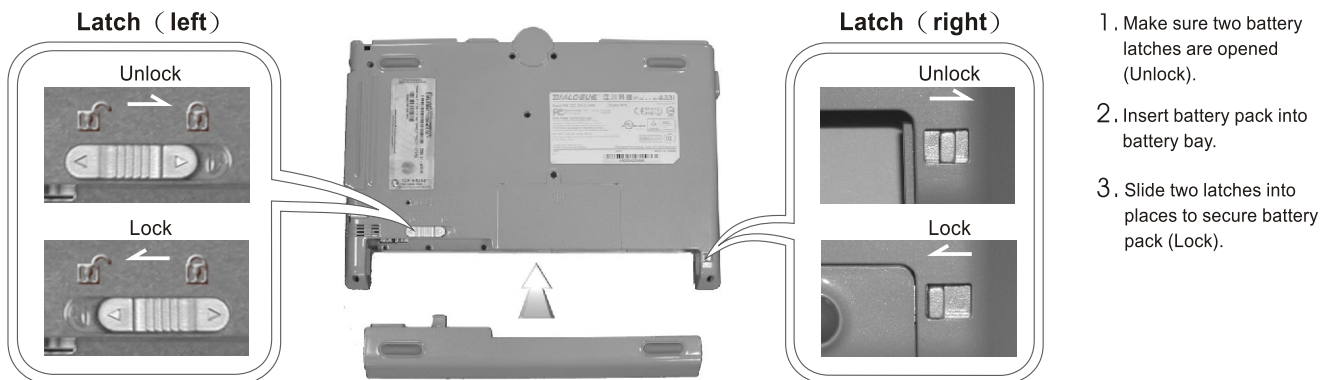

2 Connecting AC adapter to supply power

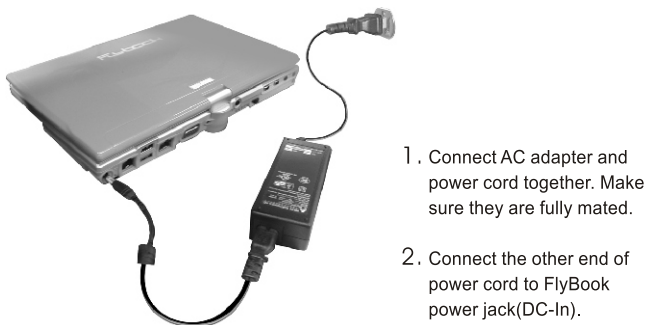

3 Turning on FlyBook and doing initial setup

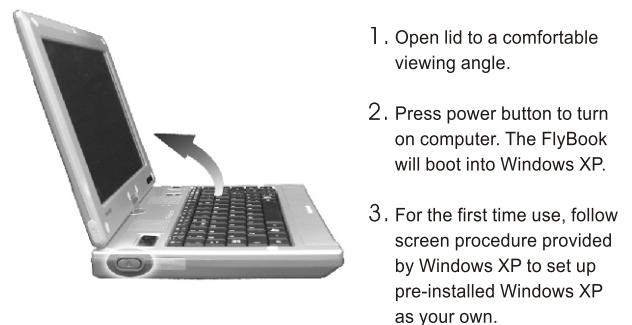

Using FlyBook

See FlyBook V2/V3 Series Users Guide to use or manage your FlyBook.

DIALOGUE